

Installing Cladding Horizontally

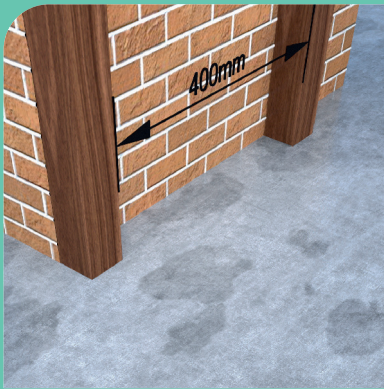

1) Install wooden / aluminium or composite battens to desired area at 400mm centres.

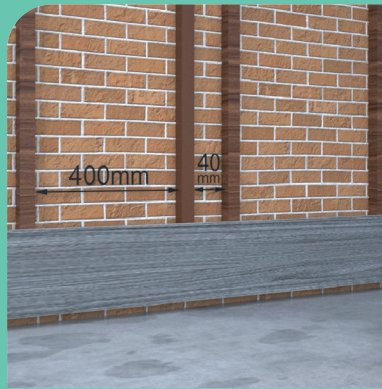

2) Please ensure where boards butt together additional battens are added as per photo.



3) Install starter bar, ensuring that it is at least 30mm from the ground.

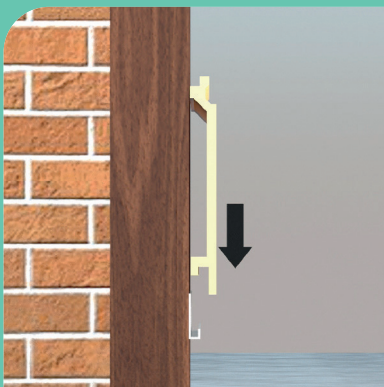

4) Now install cladding board, ensuring the cladding board is resting into the starter trim.

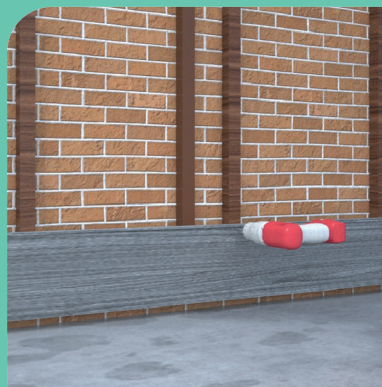

5) Secure cladding board in place by screwing supplied screws in pre drilled holes. Please remember not to screw to tight, TRUclad needs to be able to expand and contract.

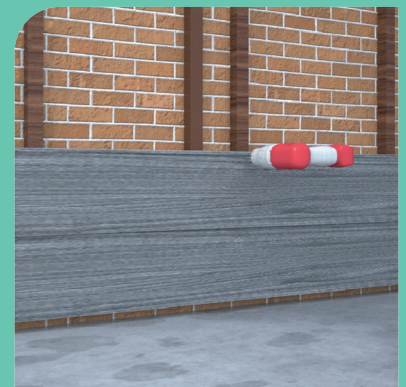

6) Repeat process to achieve desired height.

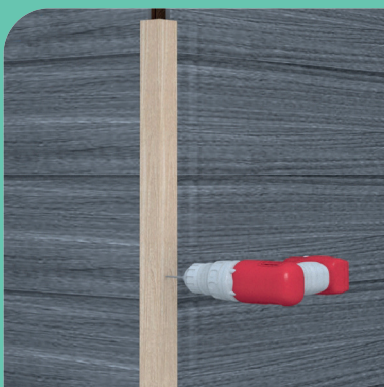

7) Finish cladding area by using angle trim, secure using coloured screws, please ensure you use countersink drill bit supplied in order to pre drill holes.

TRUclad is owned by Falcon Timber, a Consolidated Timber Holdings Group Member. Falcon Timber Ltd will take no responsibility for installation issues that arise where installer(s) have not followed the installation guide, resulting in the warranty being voided.

Falcon Timber Ltd will take no responsibility for scratching and/or poor maintenance of TRUclad composite cladding.

For more information please visit www.falcon-timber.com or email truclad@falcon-timber.com

For more details and technical information about TRUclad - please get in touch with your local distributor.



TRUclad is owned by Falcon Timber, a Consolidated Timber Holdings Group Member. For more information, please visit www.falcon-timber.com
Falcon Timber Ltd reserves the right to alter specifications without notice.

Installing Cladding Vertically



1) Install wooden / aluminium or composite battens to desired area at 400mm centres.



2) Please ensure where boards butt together additional battens are added as per photo.



3) Install starter bar, ensuring that it is at least 30mm from the ground.

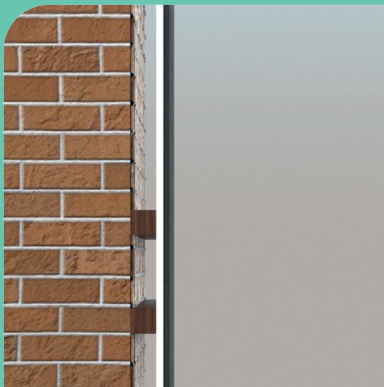

4) Now install cladding board, ensuring the cladding board is resting into the starter trim.

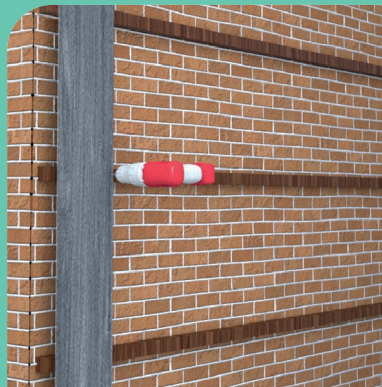

5) Secure cladding board in place by screwing supplied screws in pre drilled holes. Please remember not to screw to tight, TRUclad needs to be able to expand and contract.

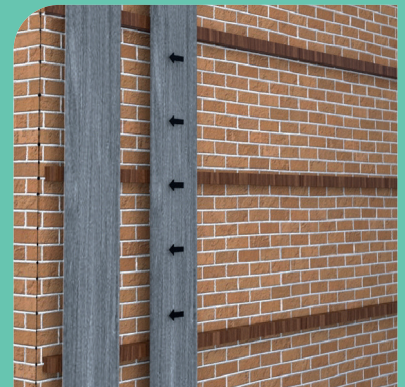

6) Repeat process to achieve desired length.



7) Finish cladding area by using angle trim, secure using coloured screws, please ensure you use countersink drill bit supplied in order to pre drill holes.

TRUclad is owned by Falcon Timber, a Consolidated Timber Holdings Group Member. Falcon Timber Ltd will take no responsibility for installation issues that arise where installer(s) have not followed the installation guide, resulting in the warranty being voided.

Falcon Timber Ltd will take no responsibility for scratching and/or poor maintenance of TRUclad composite cladding.

For more information please visit www.falcon-timber.com or email truclad@falcon-timber.com

For more details and technical information about TRUclad - please get in touch with your local distributor.



TRUclad is owned by Falcon Timber, a Consolidated Timber Holdings Group Member. For more information, please visit www.falcon-timber.com
Falcon Timber Ltd reserves the right to alter specifications without notice.